

○ NOTES  
 © This drawing is copyright of Condy and Lofthouse Ltd. and may not be reproduced in any way without their specific permission.

**GENERAL NOTES:**  
 1. This scheme is subject to detail design development and relevant site surveys  
 2. Internal windows and doors not indicated - to be finalised with elevational design

**UNIT B**  
 10 BED LSU  
 (LOW SECURE UNIT)

**UNIT E**  
 7 BED ATU  
 (ASSESSMENT TREATMENT UNIT)

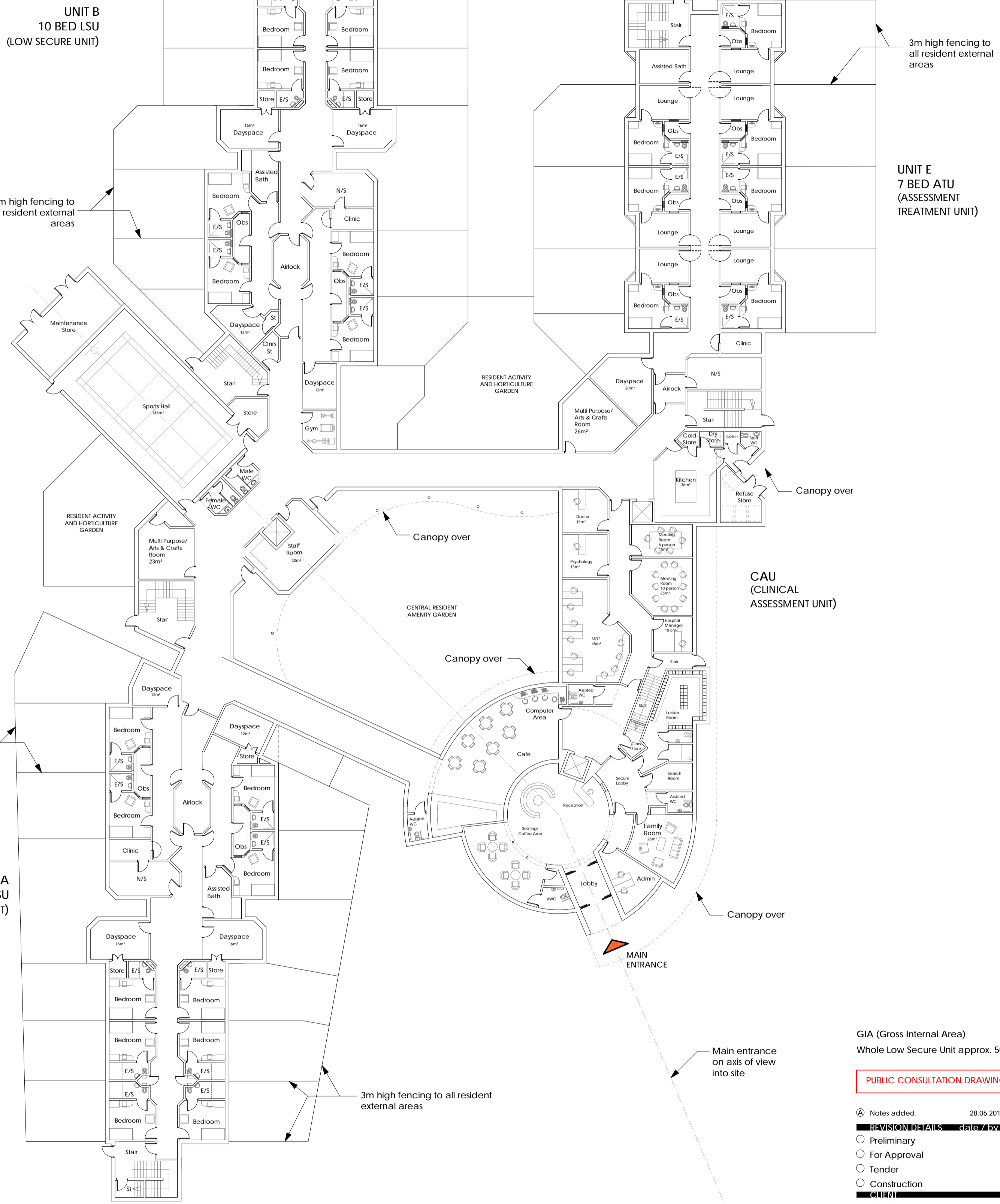

**UNIT A**  
 10 BED LSU  
 (LOW SECURE UNIT)

GIA (Gross Internal Area)  
 Whole Low Secure Unit approx. 5000m<sup>2</sup>

**PUBLIC CONSULTATION DRAWING**

- Ⓐ Notes added. 28.06.2017 JC
- REVISION DETAILS date / by
- Preliminary
- For Approval
- Tender
- Construction

**CLIENT**  
 ASC Realstate Investments Ltd

**PROJECT**  
 Proposed Low Secure Units & Housing  
 Mold Road, Gwersyllt  
 Wrexham LL11 4AF

**DRAWING TITLE**  
 Low Secure Unit - Ground Floor Plan - As Proposed

**SCALE** 1:250@A2 drawn by MP date 20.06.2017

**DRAWING CODE** 17-032-SK33 revision Ⓐ



T: 0151 207 4371 • F: 0151 207 7087

**GROUND FLOOR PLAN - LOW SECURE UNIT**

www.condylofthouse.co.uk • info@condylofthouse.co.uk • Liverpool • L5 9PR • E: info@condylofthouse.co.uk • 24 Derby Road • Unit 17 • Connect Business Village • Wrexham LL11 4AF